



**BISTRO 12 VOLT STRING KIT**  
PRODUCT & INSTALLATION  
**GUIDE**



# TABLE OF CONTENTS

<b>BISTRO 12 VOLT STRING KIT .....</b>	<b>3</b>
<b>BISTRO STRING END CAP.....</b>	<b>5</b>
INSTALLING THE BISTRO STRING END CAP.....	5
<b>STRAIGHT CONNECTOR .....</b>	<b>6</b>
INSTALLING STRAIGHT CONNECTOR TO LANDSCAPE CABLE .....	7
INSTALLING STRAIGHT CONNECTOR TO SO CABLE .....	11
<b>T CONNECTOR.....</b>	<b>14</b>
INSTALLING T CONNECTOR TO SO CABLE .....	15
<b>CABLE TERMINAL INSTRUCTIONS .....</b>	<b>19</b>
ATTACHING THE STRAIGHT CONNECTOR TO THE LANDSCAPE CABLE.....	19
ATTACHING THE STRAIGHT CONNECTOR TO THE SO CABLE.....	22
ATTACHING THE T CONNECTOR TO THE SO CABLE .....	25

Cover Photograph Courtesy of Bryant Outdoor Lighting

# BISTRO 12 VOLT STRING KIT



Part Numbers:  
**BISTROKIT-26-12V-NL**  
**BISTROKIT-50-12V-NL**  
**BISTROKIT-98-12V-NL**  
**BISTROKIT-150-12V-NL**

## DESCRIPTION

A great addition to any outdoor lighting job, bistro lights add a touch of elegance and ambience for entertaining, the Brilliance Bistro 12 Volt String Kit comes in 26 ft., 52 ft, 98 ft and 150 ft kit options. Use this low voltage bistro string with the corresponding low voltage string connection accessories for custom length bistro lighting. This string is for use with low voltage lamps only. Dimmable with Brilliance Dimmer and most magnetic transformers. Each kit includes bistro string, and hanging kit. Lamps and connector accessories sold separately.

NEC\* Article 411.5 (B): Lighting systems shall be installed not less than 3m (10ft) horizontally from the nearest edge of the water, unless permitted by Article 680.

# BISTRO 12 VOLT STRING KIT

## FEATURES

- Available in 26 ft, 50 ft, 98 ft and 150 ft
- Features Brilliance Patented 2-Way Mounting System
- Bistro String, and Hanging Kit Included
- Lamps and String Connector Accessories Sold Separately
- 2 Year Warranty

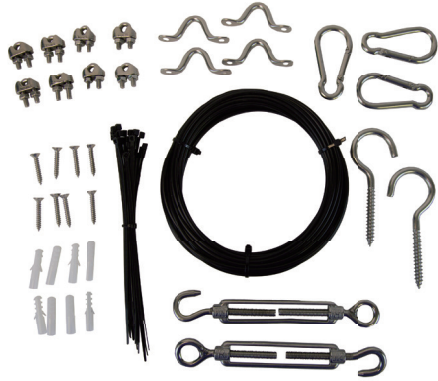

## BISTRO 12 VOLT STRING KIT SPECS

<b>Operating Range</b>	12VAC
<b>Total Length</b>	26 ft, 50 ft, 98 ft or 150 ft
<b>String Lead Length</b>	At least 10 inches of lead required for connections
<b>Distance Between Lamp Positions</b>	24 inches between lamps
<b>Connection Accessories Available</b>	Straight Connector: 1 per cable conversion T Connector: 1 per center feed End Cap: 1 per string end
<b>Includes</b>	Low Voltage Bistro String (14 AWG)

## S14 LAMP REQUIREMENTS

Lamp	1W, 12 VAC	2W, 12 VAC	3.5W, 12 VAC
<b>Max. # of Lamps</b>	75	50	30
<b>Max. Wattage</b>	125.25 with VA	117.5 with VA	117.9 with VA
<b>Max. String Length</b>	150 ft end-to-end	100 ft end-to-end	60 ft end-to-end

# BISTRO STRING END CAP



Part Number:

**LOW-VOLTAGE-BISTRO-STRING-END-CAP**

## DESCRIPTION

The Low Voltage Bistro String End Cap is an accessory to customize the length of the Low Voltage Bistro String Reel only. Use with Brilliance Low Voltage Bistro String for wherever you have an end of SO cord. Order one Low Voltage Bistro String End cap for each string end.



**FAILURE TO FOLLOW  
INSTRUCTIONS WILL  
VOID WARRANTY**

## INSTALLING THE BISTRO STRING END CAP

1. Examine the end of the SO cable.
2. Be certain that none of the conductors or strands of cable are touching each other.
3. Apply a small amount of silicone to the end of the SO cable.
4. Slide the end cap over the SO cable jacket to secure it. Refer to the silicon manufacturer's information for the recommended cure time.

# STRAIGHT CONNECTOR



Part Number:

## LOW-VOLTAGE-BISTRO-STRING- STRAIGHT-CONNECTOR

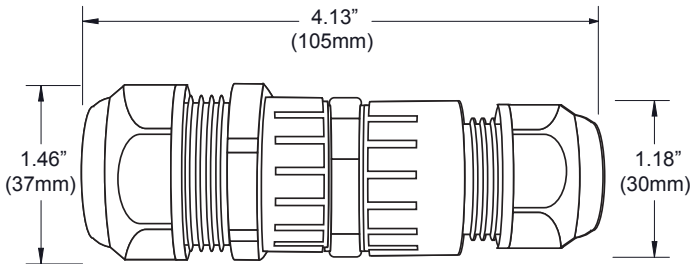

### DESCRIPTION

The Low Voltage Bistro String Straight Connector is an accessory to customize the length of the Low Voltage Bistro String Reel only. Use with Brilliance Low Voltage Bistro String to convert low voltage landscape lighting cable to SO cable. Order one Low Voltage Bistro String Straight Connector for each instance in which you have to convert low voltage landscape lighting cable to SO cable.



**FAILURE TO FOLLOW  
INSTRUCTIONS WILL  
VOID WARRANTY**

# INSTALLING STRAIGHT CONNECTOR TO LANDSCAPE CABLE

1. Unscrew the plastic nut from the straight connector.



2. Using some needle nose pliers, gently remove the two-hole rubber grommet from the throat coupler.

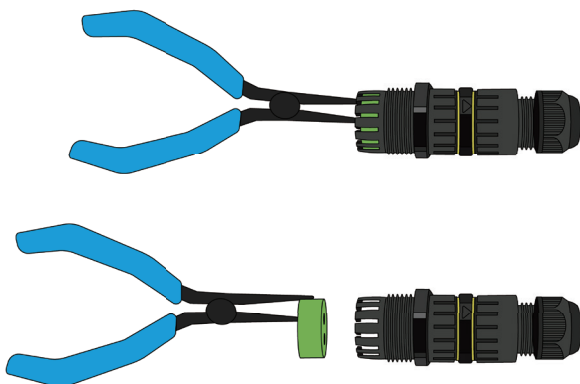

3. Unscrew the throat coupler from the center coupler.

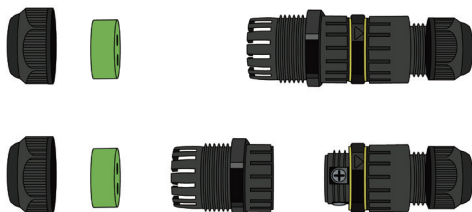

## CONTINUED

4. Using a Philips screwdriver, unscrew the two cable terminals on either side from each other. The middle terminal is not used for two conductor landscape cable.

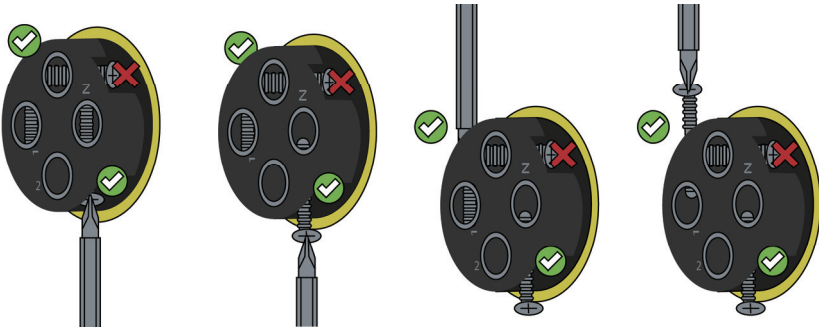

5. Strip the landscape cable approximately 1/2 inch.



6. Pass the landscape cable through the nut rounded side first.

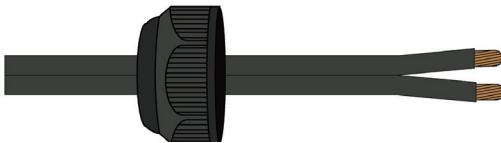

7. Splitting the cable apart, insert each conductor through the holes of the two-hole rubber grommet.





8. Pass the landscape cable through the large side of the throat coupler with the fin side first.



9. Insert one side of the split cable into the open cable terminals and tighten the terminal screw. Repeat this step for the other side of the split cable.

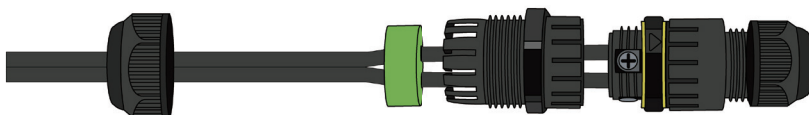

**NOTE:** See page 19 for specific details about cable connection requirements.

10. Once both conductors have been attached, thread the throat coupler to the center coupler on the terminal side and screw them together to tighten.

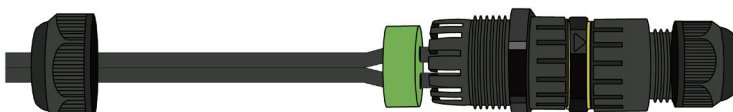

11. Position the two-hole rubber grommet into the fin side of the throat coupler.



## CONTINUED

12. Thread the compression nut back on to the fin side of the throat coupler.



13. Hand tighten until the landscape cable has been compressed. Do not over-tighten.

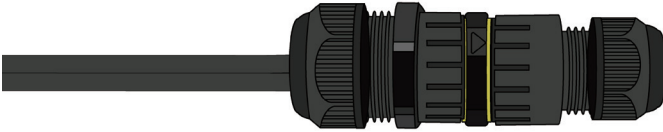

**Continue to the next page for instruction on attaching the SO cable to the other side of the straight connector.**

# INSTALLING STRAIGHT CONNECTOR TO SO CABLE

1. Unscrew the plastic nut from the SO Cable side of the connection.

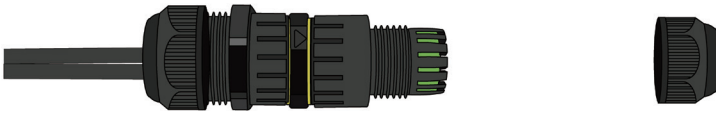

2. Using some needle nose pliers, gently remove the one-hole rubber grommet from the throat coupler.

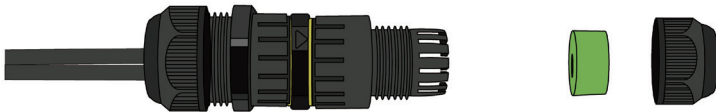

3. Unscrew the throat coupler from the center coupler.

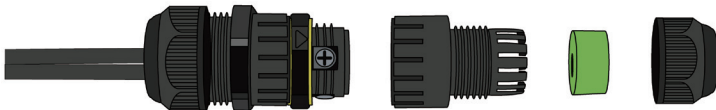

4. Using a Philips screwdriver, unscrew the two cable terminals on either side from each other. The middle terminal is not used for two conductor SO cable.

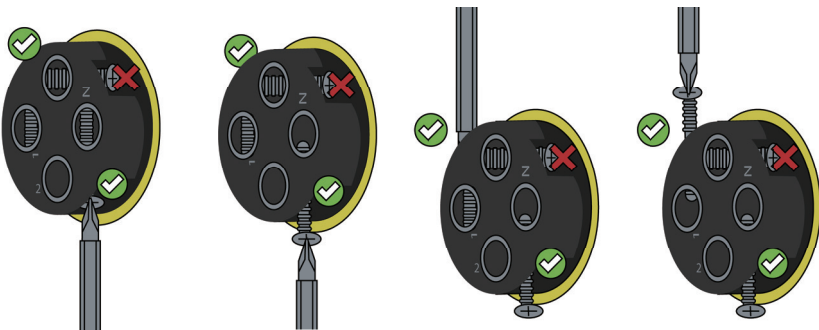

## CONTINUED

- 5.** Strip the SO cable to reveal the black and white conductors, approximately 1-1/2 inches.



- 6.** Pass the plastic compression nut over the SO cable with the rounded side first.



- 7.** Insert the SO cable through the hole of the rubber grommet.

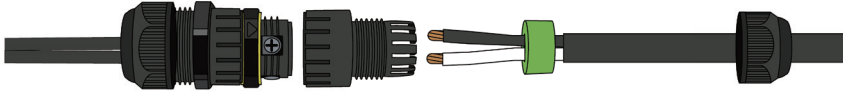

- 8.** Pass the SO cable through the small side of the throat coupler with the fin side first.

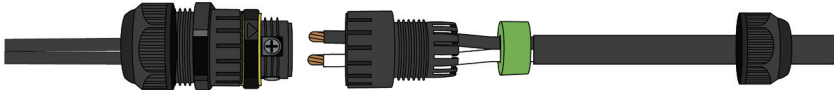

9. Insert the black and white conductors into the opened terminals. Tighten both terminal screws.

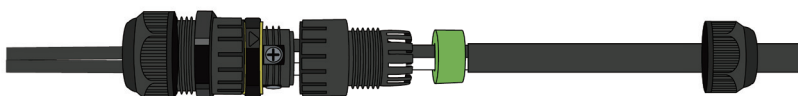

**NOTE:** See page 22 for specific details about cable connection requirements.

10. Once both conductors have been attached, thread the throat coupler to the center coupler on the terminal side and screw them together to tighten.

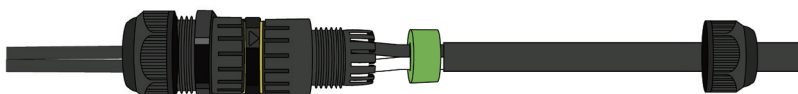

11. Position the one-hole rubber grommet into the fin side of the throat coupler.

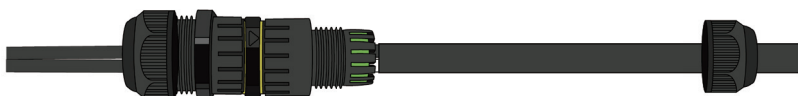

12. Thread the compression nut back on to the fin side of the throat coupler. Hand tighten until the SO cable has been compressed. Do not over-tighten.

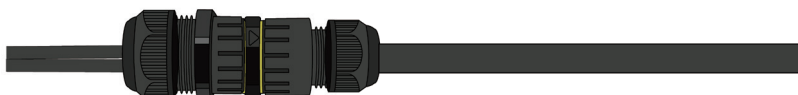

# T CONNECTOR



Part Number:

## LOW-VOLTAGE-BISTRO-STRING- T-CONNECTOR

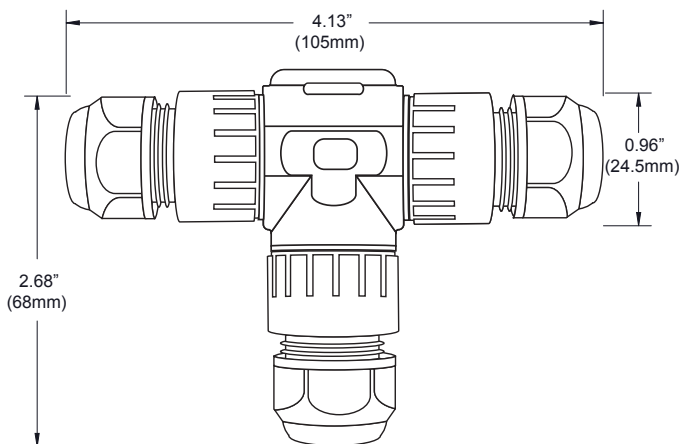

### DESCRIPTION

The Low Voltage Bistro String T Connector is an accessory to customize the length of the Low Voltage Bistro String Reel only. Use with Brilliance Low Voltage Bistro String for wherever you want to change directions, or when you need to combine two sections of SO cable. Order one Low Voltage Bistro String T Connector for each center feed used.



**FAILURE TO FOLLOW  
INSTRUCTIONS WILL  
VOID WARRANTY**

# INSTALLING T CONNECTOR TO SO CABLE

1. Unscrew the plastic nut from the SO Cable side of the connection.

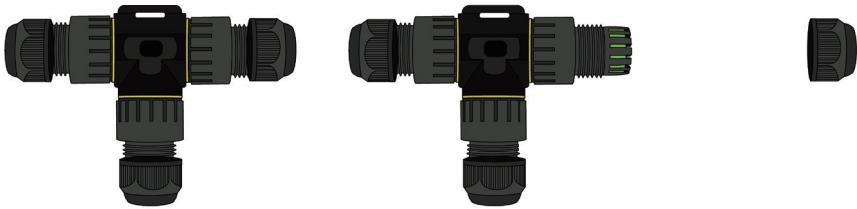

2. Using some needle nose pliers, gently remove the one-hole rubber grommet from the throat coupler.

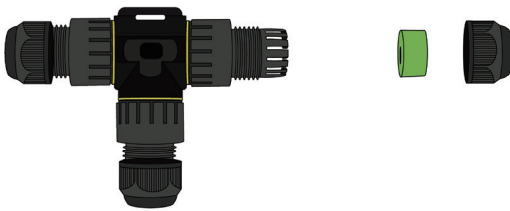

3. Unscrew the throat coupler from the center coupler.

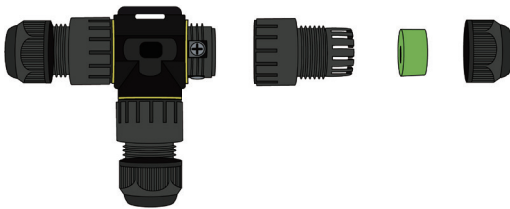

## CONTINUED

- Using a Philips screwdriver, unscrew the two cable terminals on either side from each other. The middle terminal is not used for two conductor SO cable.

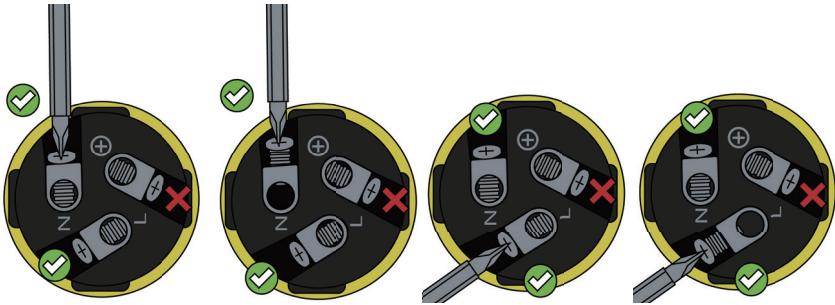

- Strip the SO cable to reveal the black and white conductors, approximately 1-1/2 inches.



- Pass the plastic compression nut over the SO cable with the rounded side first.

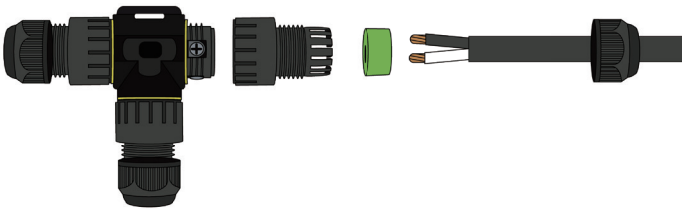



7. Insert the SO cable through the hole of the rubber grommet.

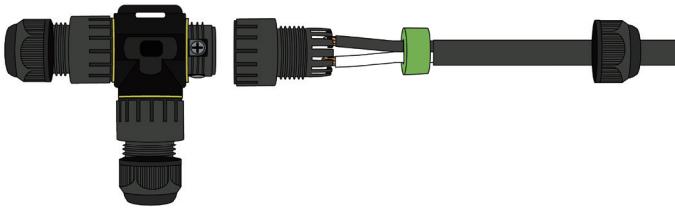

8. Pass the SO cable through the large side of the throat coupler with the fin side first.

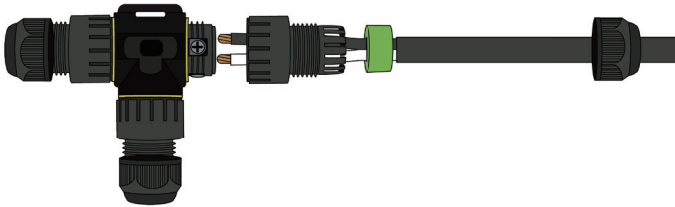

9. Insert the black and white conductors into the opened terminals. Tighten both terminal screws.

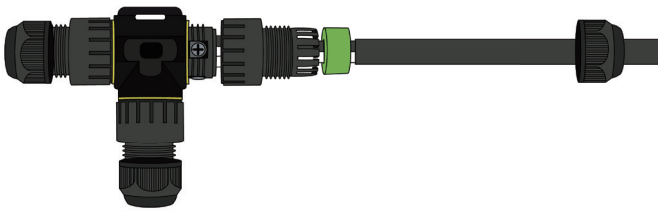

**NOTE:** See page 25 for specific details about cable connection requirements.

## CONTINUED

10. Once both conductors have been attached, thread the throat coupler to the center coupler on the terminal side and screw them together to tighten.

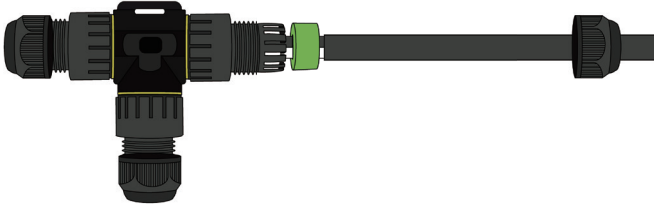

11. Position the one-hole rubber grommet into the fin side of the throat coupler.

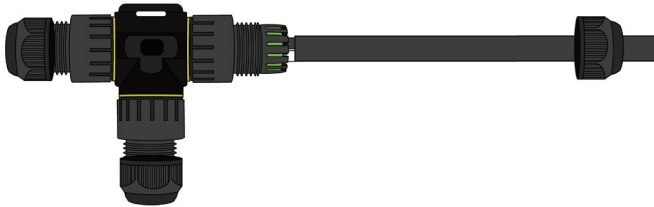

12. Thread the compression nut back on to the fin side of the throat coupler. Hand tighten until the SO cable has been compressed. Do not overtighten.

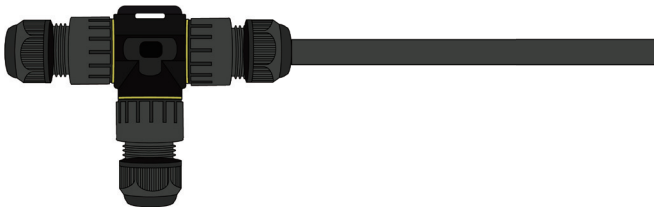

**Repeat steps 1-12 on each side of the T Connector to complete.**

# CABLE TERMINAL INSTRUCTIONS:

## ATTACHING THE STRAIGHT CONNECTOR TO THE LANDSCAPE CABLE

1. Using a Philips screwdriver, unscrew the two cable terminals on either side from each other. The middle terminal is not used for two conductor landscape cable.

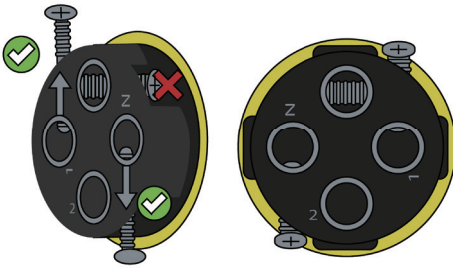

2. Insert the landscape cable into one of the open terminals.

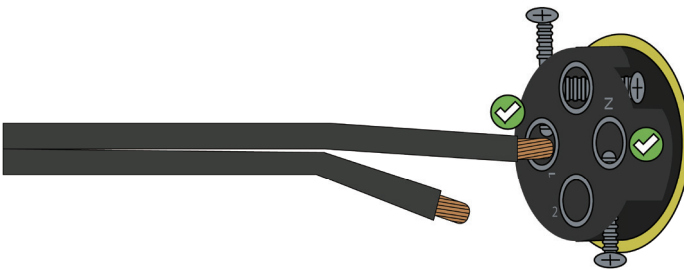

# CONTINUED

- 3. Once the cable is inserted, hold the cable in place and use a Phillips screwdriver to tighten the screw.

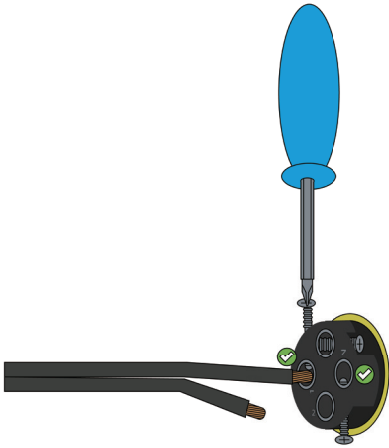

- 4. Once the screw is tightened, the connection is complete.

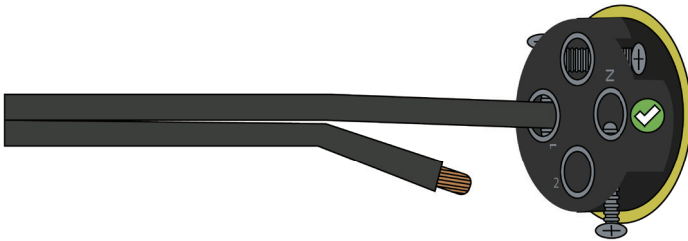

- 5. Insert the other cable into the second open terminal.

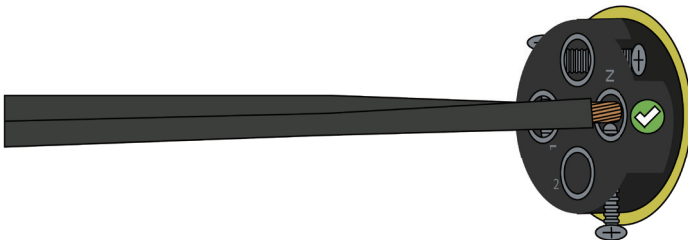

- 6.** Once the second cable is inserted, hold the cable in place and use a Phillips screwdriver to tighten the screw.



- 7.** Once the screw is tightened, both connections are complete.

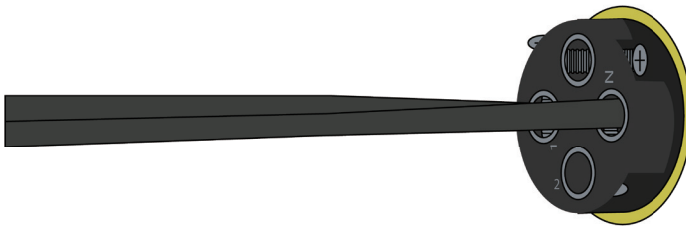

# CABLE TERMINAL INSTRUCTIONS: ATTACHING THE STRAIGHT CONNECTOR TO THE SO CABLE

1. Using a Philips screwdriver, unscrew the two cable terminals on either side from each other. The middle terminal is not used for two conductor SO cable.

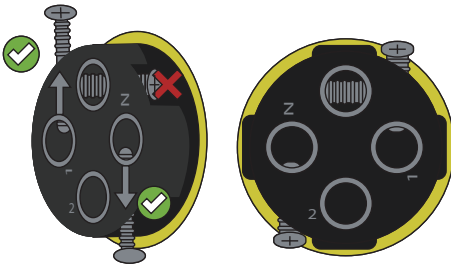

2. Insert the black cable into the terminal marked 1.

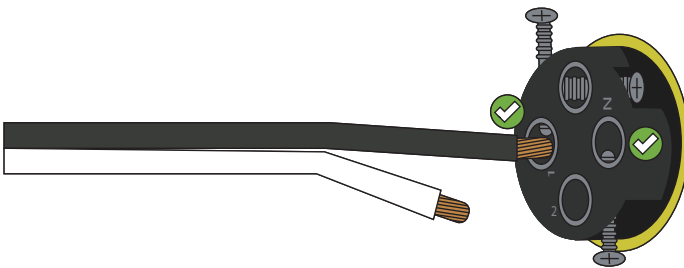

## CONTINUED

3. Once the cable is inserted, hold the cable in place and use a Phillips screwdriver to tighten the screw.

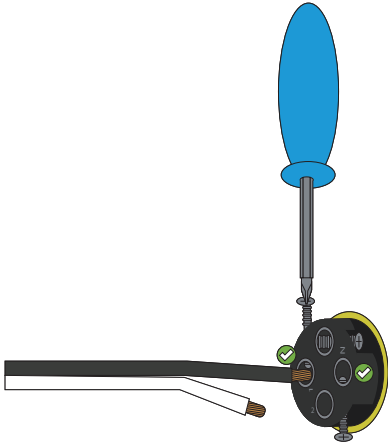

4. Once the screw is tightened, the connection is complete.

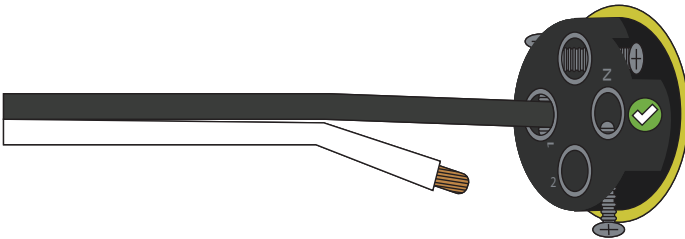

5. Insert the white cable into the terminal marked N.

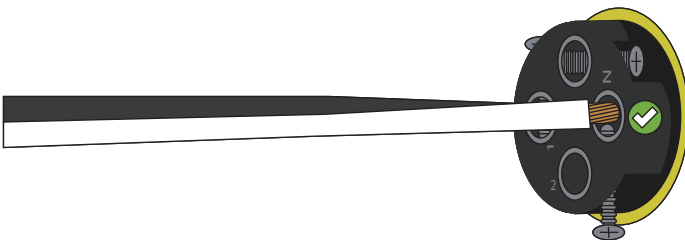

6. Once the second cable is inserted, hold the cable in place and use a Phillips screwdriver to tighten the screw.



7. Once the screw is tightened, both connections are complete.

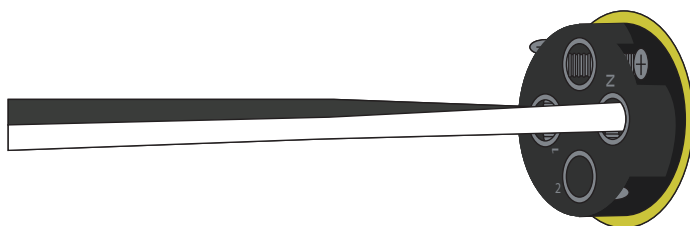



# CABLE TERMINAL INSTRUCTIONS:

## ATTACHING THE T CONNECTOR TO THE SO CABLE

1. Using a Philips screwdriver, unscrew the two cable terminals on either side from each other. The middle terminal is not used for two conductor SO cable.

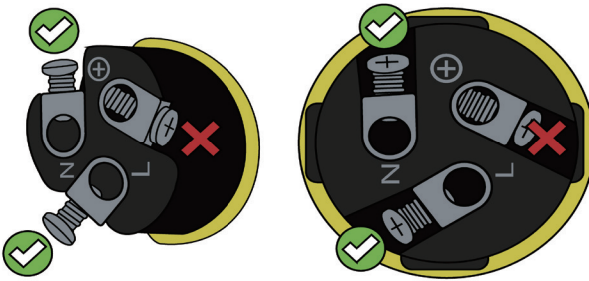

2. Insert the white cable into the terminal marked N.

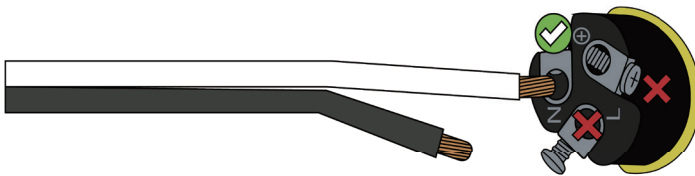

3. Once the cable is inserted, hold the cable in place and use a Phillips screwdriver to tighten the screw.

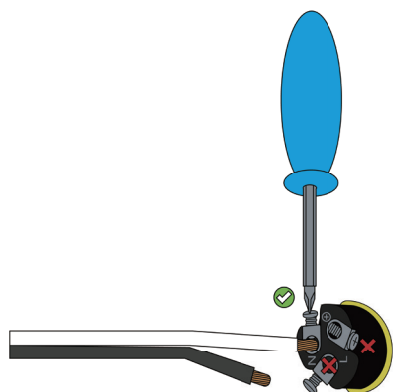

4. Once the screw is tightened, the connection is complete.

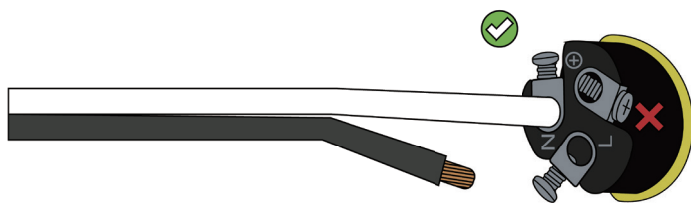

5. Insert the black cable into the terminal marked L.

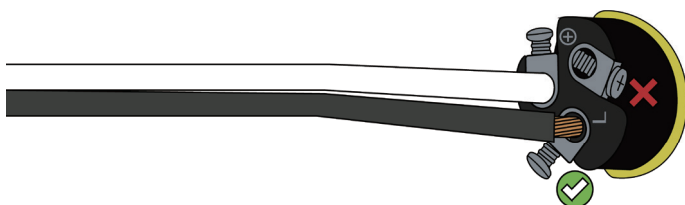

## CONTINUED

6. Once the second cable is inserted, hold the cable in place and use a Phillips screwdriver to tighten the screw.

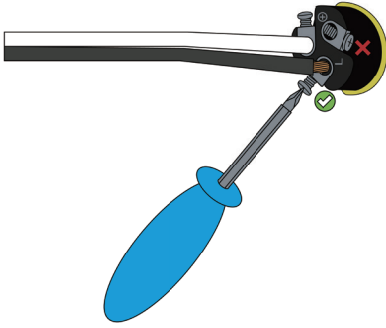

7. Once the screw is tightened, both connections are complete.

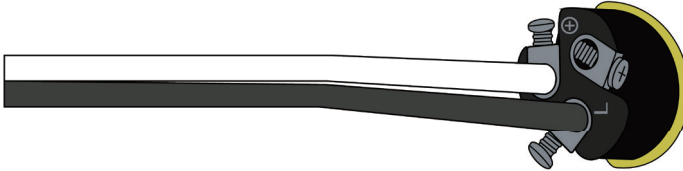



brillianceled.com | 800.867.2108  
7202 E Cave Creek Rd, Suite 3A  
PO Box 2281 Carefree, AZ 85377