

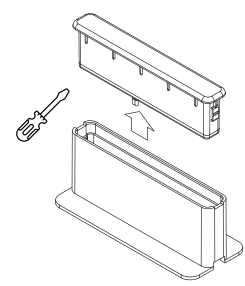

PAVER LIGHT

PRODUCT DESCRIPTION

The Command Series Paver Light blends sleek design with advanced smart control for a seamless outdoor lighting experience. Built with an aluminum body and finished in black, it integrates cleanly into patio and hardscape pavers for a refined, architectural look. Featuring a self-contained control network with no Wi-Fi, hubs, or repeaters required, it delivers instant dimming and selectable color temperatures of 2700K, 3000K, 4000K, and 5000K. Using a dedicated remote, users can easily adjust both Kelvin temperature and wattage on the spot. Designed with a serviceable light module, the fixture allows for quick module replacement without the need to remove surrounding pavers, simplifying maintenance and minimizing disruption to hardscape installations. With secure, reliable performance, the Command Series sets a new standard for plug-and-play smart landscape lighting.



SERVICEABLE MODULE

Pull out design for easy replacement & maintenance

PRODUCT FEATURES

- **Serviceable light module allows easy replacement without removing surrounding pavers.**
- Integrated LED paver light for architectural hardscape and landscape applications
- Corrosion-resistant aluminum housing with durable black powder-coated finish
- Flush-mount design for patios, walkways, and paver systems
- No Wi-Fi, hubs, or repeaters required; fully functional offline
- CRI >92, ultra-low VA, 1.5-4W options, 2700, 3000, 4000, 5000 Kelvin, UL certified with 50,000-hour life

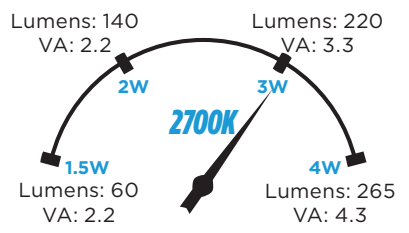

For more information on Command Series Paver Light visit: brillianceled.com/command-series-paver-light